

# GUIDE FOR 3GPP RAN WGs February Intercontinental Athens

## 27 February – 3 March 2023

- [Emmanuelle.Wurffel@etsi.org](mailto:Emmanuelle.Wurffel@etsi.org)
- ETSI MCC



## Outline

- The goal of this guide is to describe the architecture of this event: all 3GPP WGs will take place in two hotels, one city. Let's zoom on the logistic to make your daily life in Athens much easier.
- This guide is dedicated to the 3GPP Delegates, Chairs
- This guide is designed by MCC and the Actors



## Outline

- Welcome to Athens
- Meeting rooms
- Meeting access control
- Opening hours
- Coffee break/Lunch
- AV & Internet network



Welcome to Athens

# 3GPP WGs Feb-March 2023 Athens

<Document Ref.>



This is how you drink ouzo or tsipouro



Smashing plates is not as traditional as people might think



Its called "Sou-vla-ki"



Loads of honey varieties...

Hello: Ya-soo  
Goodbye: Ya-soo  
Cheers: Ya-mass  
Good Morning: Kah-lee-mer-ah

Find more  
information on Athens  
in [Athens magazine](#)



## COVID19 measures

### Use of face masks:

- Measures set at the beginning of this year in Greece required the mandatory use of face masks in public transportation as well as in hospitals/diagnostic centres/clinics. Those measures are applicable until the end of February 2023 however, as the measures are about to be removed, there is now quite some relaxation when it comes to their enforcement. As a result, it should not come as a surprise if you notice people not wearing face masks in the metro/trams etc.



## Transportation

- Info on **public transportation** from the airport: [Athens International Airport - Public transportation \(aia.gr\)](https://aia.gr).
- Info on **fixed price taxi** from the airport: [Athens International Airport - Taxi & limousine \(aia.gr\)](https://aia.gr).
- Probably the most convenient way to get around in Athens with a taxi is to use one of the known apps like **Uber** or **FreeNow**. That guaranties that regardless of how short your trip is, you will always get a receipt at the end of it.





## Location info

- The area around the hotel might not have many dinner options, however the hotel is quite close to the city centre.
- The closest metro station is called “**Syngrou-Fix**” and according to googlemaps it is 650m from the meeting hotel. From the metro station “Syngrou-Fix” the following 2 stops are “Acropolis” and “Syntagma square”.
  - o **Acropolis metro station:** is next to the Acropolis museum and ...the Acropolis. That is also the metro station to get off to go out for dinner in the areas of **Koukaki** or **Plaka (old town)**. This station is 1.4Km from the meeting hotel.
  - o **Syntagma square (constitution square) metro station:** could be considered as the centre of Athens, it is located just opposite the parliament and next to the national garden. There are loads of restaurant and bar options around . That is also the area to find a number of Asian restaurants. This station is 2.3Km from the meeting hotel.



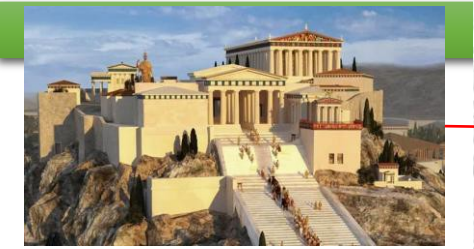

SA1and RAN WGs are here

SA & CT WGs(500m from Intercontinental)





**Tram:** “Neos Kosmos” is the closest stop (650m from the hotel) and it takes 11’/5 stops to get to the centre “Syntagma square” which is also the end of the line.

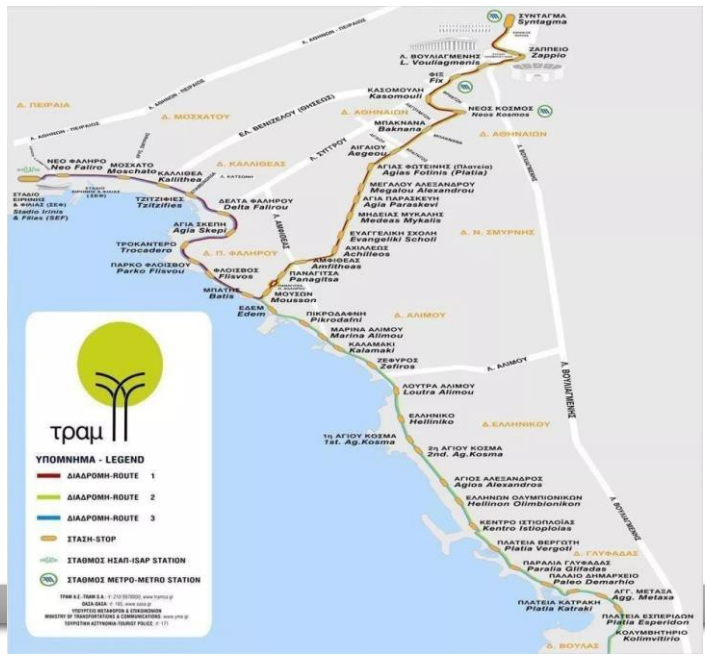

**Metro:** The closest metro station is called “Syngrou-Fix” (650m from the meeting hotel). From the metro station “Syngrou-Fix” the following 2 stops are “Acropolis” (1.4Km from the hotel) and Syntagma square (constitution square) (2.3Km from the hotel)

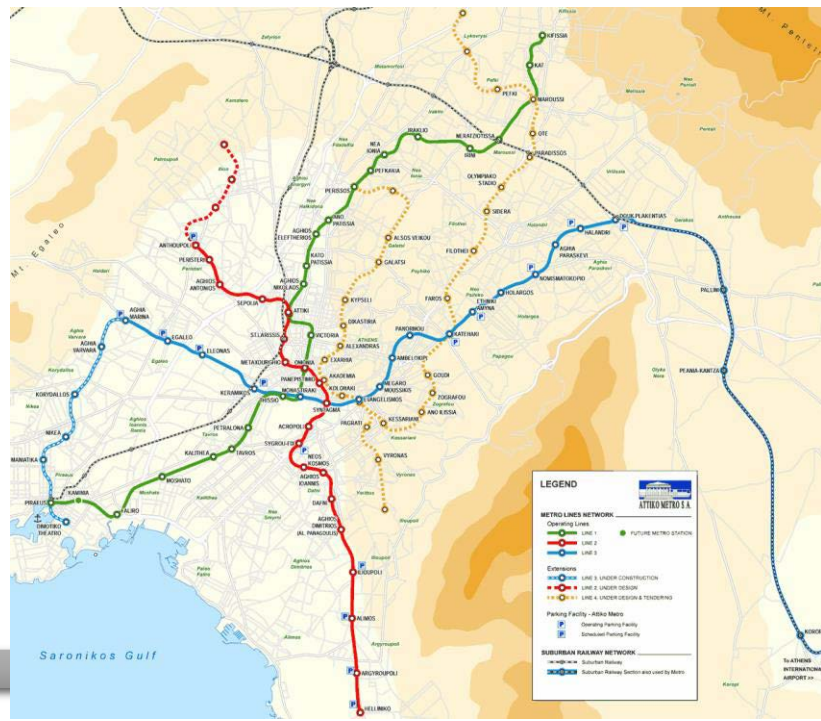

**Taxi apps:**





# Meeting rooms Layout

# GROUND LEVEL



t Ref.>



INITIATIVE



# 3GPP WGs Feb-March 2023 Athens

<Document Ref.>



TM

IVE



LEVEL -I

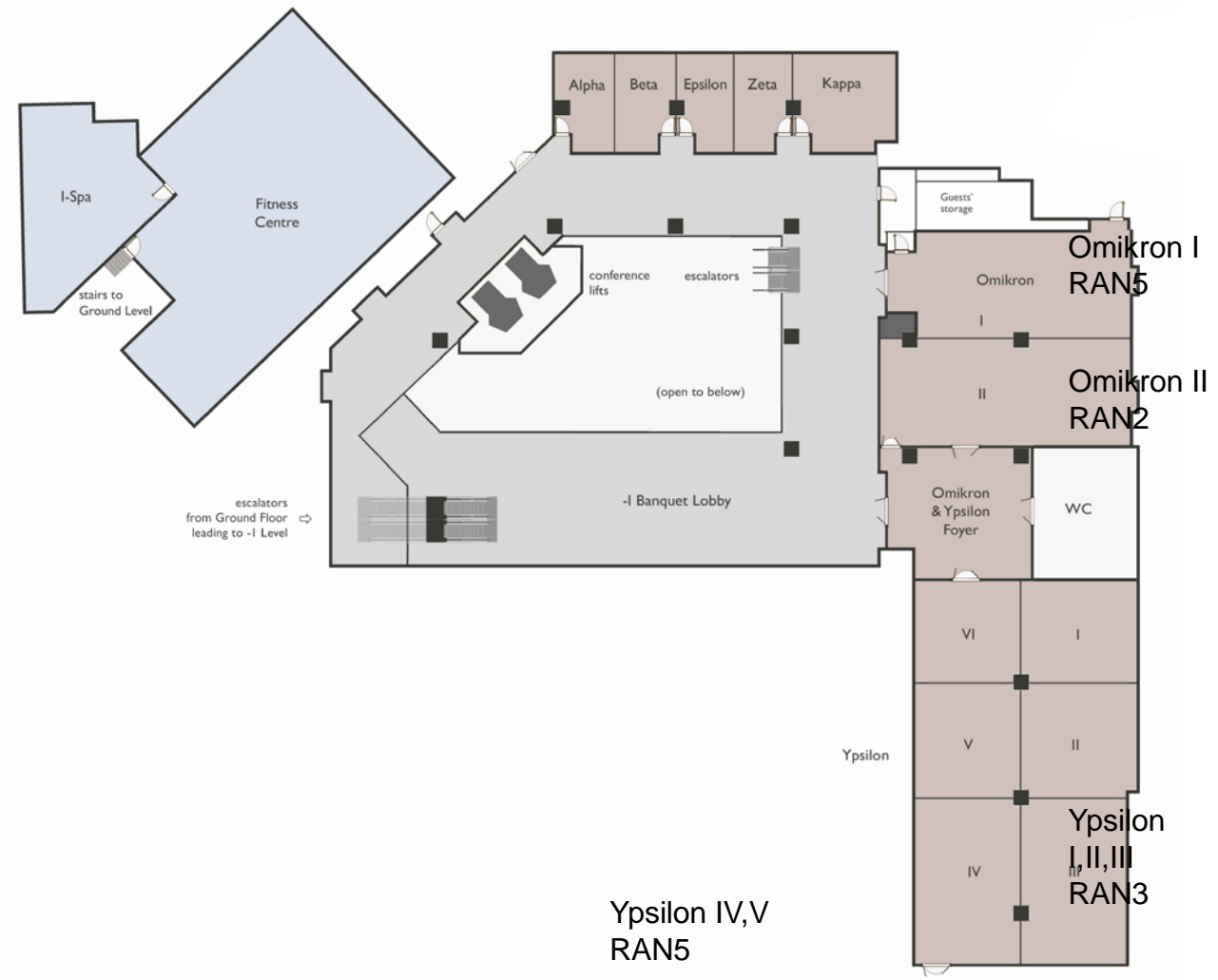

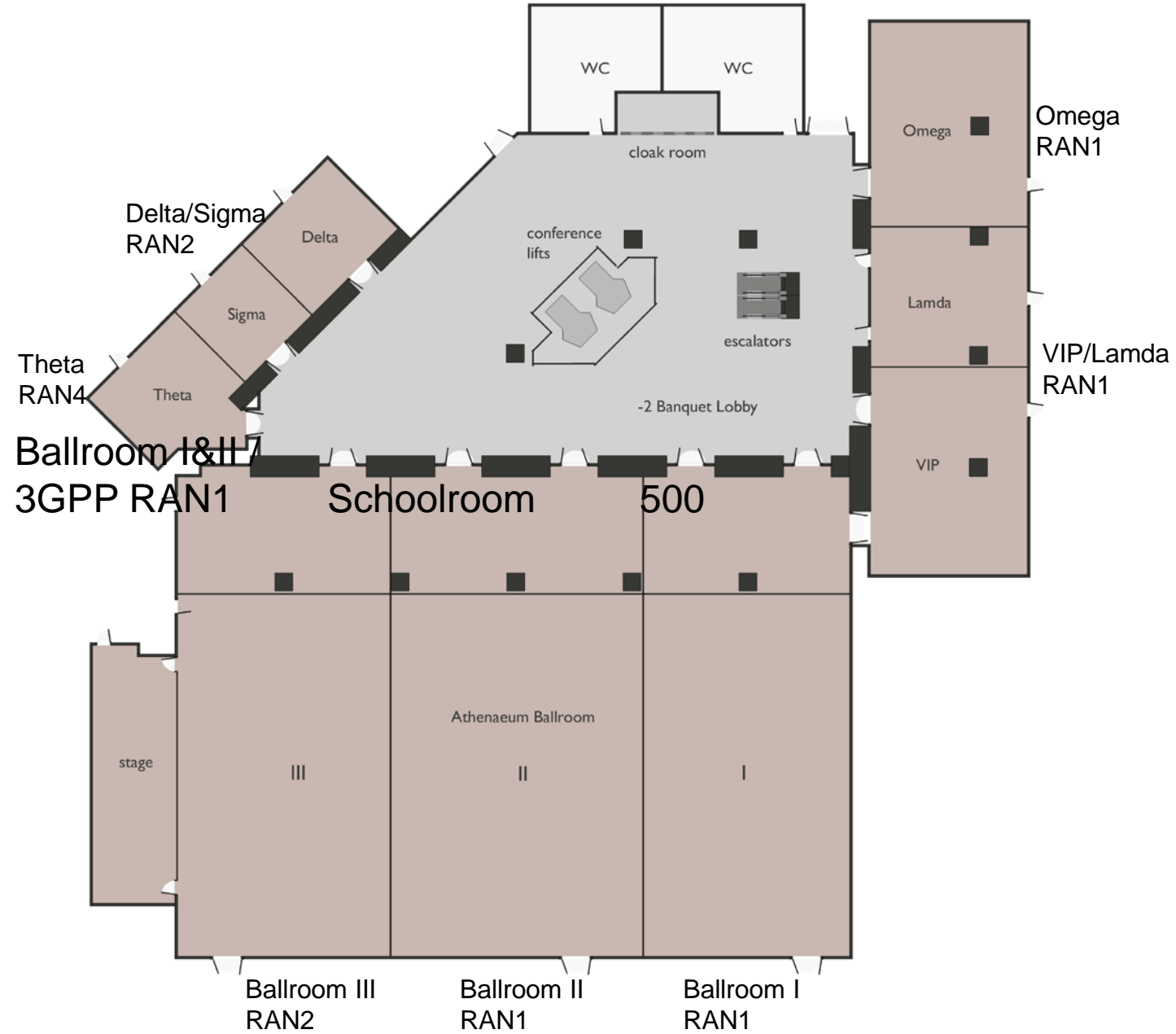

# Meeting rooms capacity





<b>RAN1:</b>	VIP/Lamda	Schoolroom	100
	Omega	Schoolroom	50
	Athenaeum Conference Center	Schoolroom	100
	Ballroom I&II	Schoolroom	500*

\*split of Ballroom I&II Monday at 13:00 and Friday 13:00

<b>RAN2:</b>	Ballroom III	Schoolroom	300
	Aphrodite III&IV	Schoolroom	120
	Delta/Sigma	Schoolroom	35
	Omikron 2	Schoolroom	80
<b>RAN3</b>	Ypsilon 1,2,3	Schoolroom	130
<b>RAN4:</b>	Aphrodite I&II	Schoolroom	230
	Arcade 1&2	Schoolroom	100
	Aphrodite 5	Schoolroom	70
	Theta	Schoolroom	20
<b>RAN5:</b>	Omikron 1	Schoolroom	50
	Ypsilon 4,5	Schoolroom	100



## Remote participation

- Remote participation will be offered in the meetings rooms using Gotomeeting, Gotowebinar or Microsoft Teams.
- Two-way audio: remote participants will be able to listen to the meeting and speak using their computer or phone.
- **F2F participants should not use the conferencing tools!**

## Raising hands

 Raising hands done via TOHRU



## Be prepared

- 📶 Delegates are urged to download the documents prior to the meeting.
- 📶 --> Massive downloads on Monday morning have a huge impact on network performance.

Process

# Meeting access control



## General process

- There will be a meeting access control in Athens, in both hotels (e.g. Intercontinental and Hyatt)
- The meeting access control is only related to hosting purposes. Therefore, to get your presence and maintain your voting rights, please enter your token (as before)
- The self-printing badge machine will be available in the lobby area in each hotel, from Sunday 19 February PM to Friday 3 March.
- You will be able to print your badge:
  - either you are staying at the Hyatt or Intercontinental hotel.
  - if you are registered to one or all events (3GPP CT WGs, SA WGs, RAN WGs)
- The control (scanning your QR code) will be made by area and not in front of each meeting rooms.



## To Process your badge

### Registration & Badge

Please register on the 3GPP Portal (same process as usual)

The confirmation email will contain the usual token as well as a QR code

Delegates already registered do not need to register again

\*While entering the meeting venue please make sure that you have your QR code available (either on paper or on your mobile phone)

\*Please scan your QR code on the self-printing desk

\*Your badge will be printed (one badge for all the groups)

Please wear your badge all week

\*to be done only the first day

## Self-printing desk on-site







## eco-badge

3GPP is environmentally friendly: you will get an **eco-badge**



Feel free to **recycle** it: before the end of your event (box available at the self-printing desk)

Intercontinental  
opening/closing time  
**07:30-20:30**

Coffee breaks

10:30-11:00 (all week) coffee break, -2 banquet lobby

16:30-17:00 (except on Friday) coffee break, -2 banquet lobby

Restaurants within Intercontinental  
special lunch/dinner offer  
to 3GPP delegates



## Café Zoe restaurant – Ground level

From 12:30pm to 14:30pm Monday to Friday, the Café Zoe invites you to lunch buffet, prepared especially for you, featuring a wide selection of Mediterranean dishes which combine international classic with **authentic Greek flavors!**

**Appetizers - buffet : €15.00/per person**

**Main course – buffet: €18.00/per person**

**Dessert – buffet: €7.00/per person**

**Full Buffet with coffee: €28.00/per person**

**Beverages:** One glass of house wine or beer or one soft drink at €3,00/per person

## Art Bistrot – Ground level

Our Art Bistrot from 12:00-23:00pm daily invites you to select from the a la carte menu.

**\*\*Special discount 20% will also apply on a la carte menu prices**



## Restaurants walking distance from Intercontinental & Hyatt Hotels

[Hytra](#) 5 min walk

[Indian Chef](#) 6 min walk

[Kalamaki bar](#) 11 min walk

[Ciao Italia](#) 11 min walk

**Louiza Athens**, <https://louiza-athens.business.site/> 3 min walk 15-20€ / person Greek cuisine

**43sarantatrio**, <https://43sarantatrio.gr/> 9 min walk 20-25€ / person Greek cuisine

**Zephyros**, <https://goo.gl/maps/2KZfJZ3qs6YTfjc48> 26 min walk

[Dei Fratelli](#) - 11 min walk

[Jaipur Palace](#) 8 min walk

[Johnie Hot Dog](#) 6 min walk

[Cafe restaurant Diverso](#) 7 min walk

!There are many more restaurants in the old town (Plaka), near Acropolis, but you have to walk 30-35min!

# Audio system



## Audio systems

- Traditional audio system in all the meeting rooms
  - Stand up microphones in the audience
  - Table microphones for the top table



# 3GPP network



## 3GPP Wireless LAN

### Wireless LAN:

SSID: 3GPPWIFI

Password: 3GPP3GPPM (CAPITAL LETTERS!)

IP address: 10.10.10.10

**--> USUAL SETTING**

## Survey

📧 We will send you a survey after the meeting.





# Summary

Thank You for attending this F2F meeting  
in Athens

Take care, stay safe, and travel safe