

CCSA and CF3 has the pleasure of welcoming you to

3GPP RAN1#118-bis

Hefei, China, 14-18 October, 2024

hosted by Chinese Friends of 3GPP (CF3)



SAMSUNG

CAICT 中国信通院



oppo



Qualcomm 美国高通公司

vivo

ZTE



HONOR

Supported by 3GPP IMs via CCSA

Hefei' s Location in China Map



Brief Introduction of Hefei



Hefei, referred to as "Lu" or "He" in ancient times, known as Luzhou, Luyang, Hefei, is a prefecture-level city in Anhui Province. It is located in the central part of Anhui Province, in the west wing of the Yangtze River delta, surrounded by Chaohu Lake.

Hefei is one of the important cradles of Chinese civilization. The East Fei River and the South Fei River both originate here, hence the name. It is an important administrative center, commercial port and military town in the Jianghuai region, known as "the right throat of the Huai River, Jiangnan Lip Tooth," "the first county of the Jianghuai River, Wu Chu Yaochong," "the hometown of the Three Kingdoms, the hometown of Bao Zheng, and the cradle of the Huai Army." It is also the central city of the G60 Science and Technology Innovation Corridor, the strategic dual-node cities of the Belt and Road Initiative and the Yangtze River Economic Belt, the comprehensive national scientific centre, the member cities of the World Alliance of Science and Technology Cities, and the national pilot cities of science and technology innovation.

Hefei' s Attractions

Bao Ancestral Hall in Hefei



- Bao Ancestral Hall, the full name of Bao Xiaosu Ancestral Hall, is located in Hefei, Anhui Province, on a mound in the eastern section of Huancheng South Road. It is a memorial hall for Bao Zheng, a minister of the Northern Song Dynasty. It was built in the Ming Dynasty and rebuilt in the Qing Dynasty. It covers an area of 10,000 square meters. Bao Gong Temple consists of a closed courtyard with white walls and green tiles. The main building is Bao Gong Ting Hall, sitting Bao Zheng tall statue, wall embedded black stone Bao Gong carved image, the majesty is not A, the performance of the "untouchable" black-faced Bao Gong's awe-inspiring righteousness. The west side of the pavilion is equipped with a corridor of curved pavilions; In the east there are 16 Longjing Pavilion stands, there are ancient wells, the number "Lian Quan." On September 8, 1981, Baogong Temple was announced by the Anhui Provincial People's Government as a provincial cultural relics protection unit in Anhui Province.

Hefei' s Attractions



Former Residence of Li Hongzhang

- The Li Mansion covers an area of 2000 square meters and the Huai Department Exhibition Hall covers an area of more than 1500 square meters. Li Fu is divided into five from south to north, followed by the foyer, lobby, the hall and Zouma Zhuan Xin Lou. The former residence is not only one of the "Top Ten Scenic Spots" of Hefei, but also the first choice of the public. It is listed as a national key cultural relics protection unit and a national AAAA tourist attraction.

- Hefei Li Hongzhang former residence, located in Hefei, Anhui Province, Luyang District, Huaihe Road, the middle section of the pedestrian street No. 208, is the late Qing Dynasty Li Hongzhang's home, typical of the late Qing Dynasty Jianghuai residential architecture. The former residence of Li Hongzhang covers an area of 3500 square meters and consists of the Li Mansion and the Huai Department Exhibition Hall.



Hefei' s Attractions

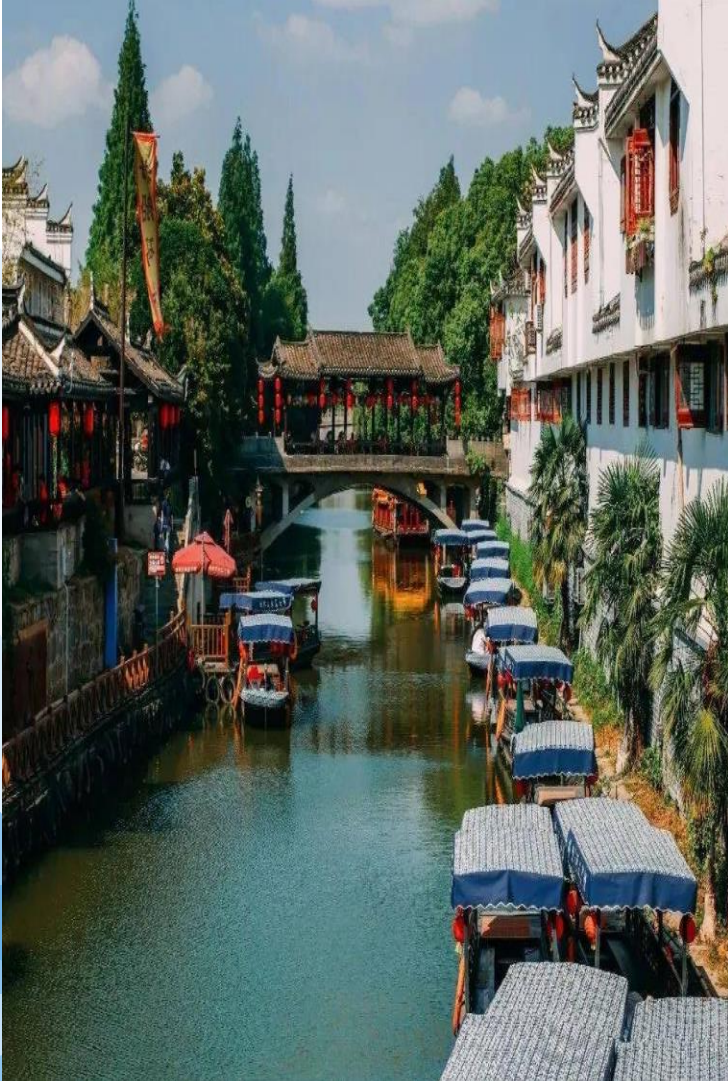

Sanhe Ancient Town

- Sanhe Ancient Town, the ancient name of Que Zhu, Que Wei (Zhu), Que An, is China's historical and cultural town, the national AAAAA level tourist attractions, located in the southern tip of Feixi County, Hefei City, Anhui Province, is located at the junction of Feixi, Lujiang, Shucheng, the ancient town with a total area of 2.9 square kilometers. Three River town was originally Chaohu in the high Island, due to sedimentation, gradually become land. In the late Northern and Southern Dynasties, said the three rivers, Ming and Qing Sanhe Town. Three River town has Fengle River, Hang River port, small Nanhe convergence in the territory, the new river flows eastward about 15 kilometers into Chaohu. In the town, there are ancient city walls, ancient artillery, the old site of the Taiping Army Command, Ying Wang Palace, One Lane, Ten thousand thousand meters, Li Fu grain warehouse, He Lu, Liu Tong Xinglong Zhuang, and other historical relics. It is the birthplace of the Lu opera. The ancient town has special products such as rice dumplings, beef sugar, sweet sugar, malt sugar, dried tea, and rice wine.

Hefei' s Attractions

Chaohu lake



- Chaohu Lake, a large freshwater lake in central Anhui Province, belongs to the Yangtze River Basin and is one of the five largest freshwater lakes in China. It is not only geographically important, but also historically, culturally and ecologically significant. Chaohu has rich aquatic resources to whitebait, beautiful white shrimp and lake crab "three fresh" known, while the lake is rich in fish resources, such as lake coilia, red culter, "four big fish," carp, crucian carp and so on. In addition, Chaohu has good navigation conditions and a number of ports and docks along the lake, which have promoted the economic development of the local and surrounding areas. Chaohu Lake is not only an important natural resource, but also a tourist attraction. Laoshan Island scenic area, tulip highland scenic area and Chaohu wetland park are tourists favorite places. These scenic spots not only show the natural beauty of Chaohu Lake, but also provide a rich tourist experience.

Local Food



Preserved mandarin fish (臭鳜鱼)



Wu Shan Gong Goose (吴山贡鹅)



Three Rivers Rice
Dumplings (三河米饺)



Luzhou roast duck (庐州烤鸭)

Hotel



The Langham Hefei

- The Langham Hefei is a great choice for guests looking for accommodation in Hefei, having been recently opened in 2018.
- Boasting a convenient location, the hotel is just 5km from Hefei West Railway Station and 44km from Xinqiao International Airport. Famous local attractions Geological Museum of Anhui, Anhui Hefei Sports Center (North Gate) and Anhui TV Station, can all be reached with a short walk.

Please take me to The Langham Hefei,
address:200 Huaining Road, Zhengwu District, Hefei, Anhui
Tel:+86-0551 6568 8888

请送我去合肥栢景朗廷酒店
地址：合肥市政务区怀宁路200号
电话：+86-0551 6568 8888

Hotel Location



Meeting Room Allocation-MON

Date	Time	Event	Function room/Capacity
14 th Oct (MON)	9:00-13:00	RAN1-1	Grand Ballroom (3F) /600
	14:30-20:00	RAN1-2	Grand Ballroom (3F) /200
	14:30-20:00	RAN1-3	Crystal Function Room (3F) /150
	14:30-20:00	RAN1-4	Pearl Function Room (2F) /150
	11:00-20:00	RAN1-5	Diamond Meeting Room A (3F) /96
	11:00-20:00	RAN1-6	Diamond Meeting Room B (3F) /96
	10:30-11:00/ 15:30-16:00	Coffee Break	Foyer

Meeting Room Allocation-TUE

Date	Time	Event	Function room/Capacity
15 th Oct (TUE)	7:30-20:00	RAN1-2	Grand Ballroom B+C (3F) /200
	7:30-20:00	RAN1-3	Crystal Function Room (3F) /150
	7:30-20:00	RAN1-4	Pearl Function Room (2F) /150
	7:30-20:00	RAN1-5	Diamond Meeting Room A (3F) /96
	7:30-20:00	RAN1-6	Diamond Meeting Room B (3F) /96
	10:30-11:00/ 15:30-16:00	Coffee Break	Foyer

Meeting Room Allocation-WED

Date	Time	Event	Function room/Capacity
16 th Oct (WED)	7:30-20:00	RAN1-2	Grand Ballroom B+C (3F) /200
	7:30-20:00	RAN1-3	Crystal Function Room (3F) /150
	7:30-20:00	RAN1-4	Pearl Function Room (2F) /150
	7:30-20:00	RAN1-5	Diamond Meeting Room A (3F) /96
	7:30-20:00	RAN1-6	Diamond Meeting Room B (3F) /96
	10:30-11:00/ 15:30-16:00	Coffee Break	Foyer

Meeting Room Allocation-THU

Date	Time	Event	Function room/Capacity
17 th Oct (THU)	7:30-20:00	RAN1-2	Grand Ballroom B+C (3F) /200
	7:30-20:00	RAN1-3	Crystal Function Room (3F) /150
	7:30-20:00	RAN1-4	Pearl Function Room (2F) /150
	7:30-20:00	RAN1-5	Diamond Meeting Room A (3F) /96
	7:30-20:00	RAN1-6	Diamond Meeting Room B (3F) /96
	10:30-11:00/ 15:30-16:00	Coffee Break	Foyer

Meeting Room Allocation-FRI

Date	Time	Event	Function room/Capacity
18 th Oct (FRI)	14:30-17:00	RAN1-1	Grand Ballroom (3F) /600
	7:30-14:00	RAN1-2	Grand Ballroom (3F) /200
	7:30-14:00	RAN1-3	Crystal Function Room (3F) /150
	7:30-14:00	RAN1-4	Pearl Function Room (2F) /150
	7:30-17:00	RAN1-5	Diamond Meeting Room A (3F) /96
	7:30-17:00	RAN1-6	Diamond Meeting Room B (3F) /96
	10:30-11:00	Coffee Break	Foyer

Welcome Social Event

Time: 19:10 - 20:30

Date: 15 October, 2024 (Tuesday)

Venue: Ballroom A (大宴会厅A) , 3F, The Langham

Sponsored by:



中国移动
China Mobile

Meeting Room Map

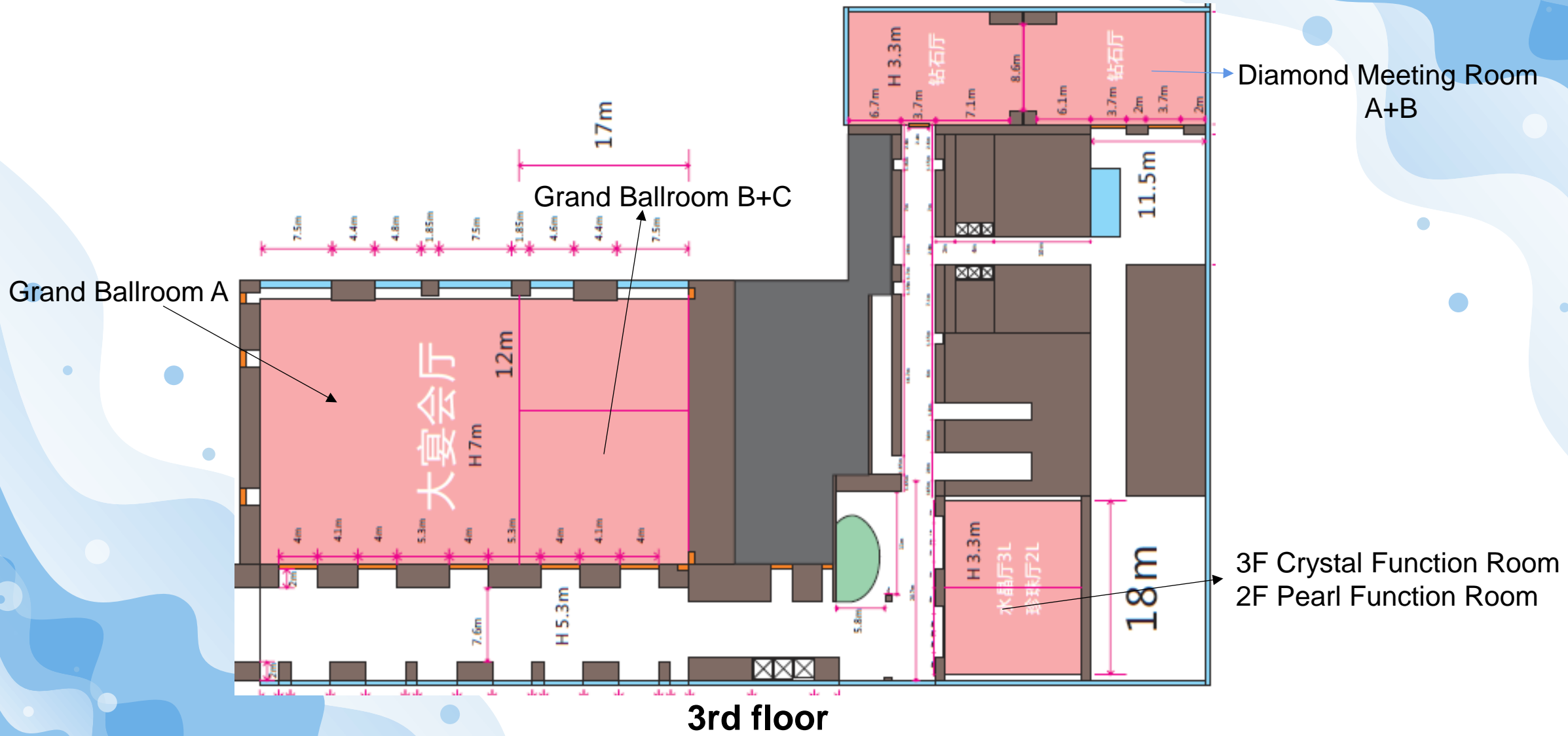

Restaurants in Hotel

THE LANGHAM
HEFEI

ENJOY CUISINE OF THE WORLD
味旅环球 饕餮自助

IN-HOUSE GUESTS CAN ENJOY
A 20% DISCOUNT ON THE
ONLINE PRICES SEASONS

住店客人可享季节餐厅
自助午餐及自助晚餐线上价格**8折**

以上优惠，服务费和税不参与折扣
Service charges and VAT are not part of the discount

12:00 - 14:30, 17:30 - 21:00

2nd Floor 2层



Restaurants in Hotel

健康菜单 HEALTHY MENU

沙拉 SALAD

- 法式尼斯沙拉配红酒醋汁 (约240千卡)
(煎金枪鱼, 生菜, 煮鸡蛋, 土豆, 四季豆, 橄榄)
French Nicoise Salad with Red Wine Vinaigrette
(Seared Tuna, Lettuce, Boiled Egg, Potato, Green Bean, Olives)
Portion/例 98
- 大虾芒果沙拉配蜂蜜柚子苹果醋 (约370千卡)
(混合生菜, 芒果, 虾仁, 小番茄)
Prawn Mango Salad with Honey Grapefruit Apple Vinaigrette
(Mixed Lettuce, Mango, Prawn, Cherry Tomato)
Portion/例 88
- 牛油果藜麦芝麻菜沙拉 (约220千卡)
(芝麻菜, 菠菜, 牛油果, 樱桃番茄, 蘑菇, 藜麦, 澳洲坚果, 搭配柠檬酱汁)
Avocado Quinoa with Arugula Salad
(Arugula, Spinach, Avocado, Cherry Tomato, Button Mushroom, Quinoa, Macadamia-Nuts Served With Lemon Dressing)
Portion/例 68



三明治 SANDWICH

- 芒果刁草烟熏三文鱼贝果三明治 (约460千卡)
Mango Dill Smoked Salmon with Bagel Sandwich
Portion/例 98
- 秘制碳烤鸡胸肉配牛油果三明治 (约520千卡)
Grilled Chicken Breast with Avocado Sandwich
Portion/例 88
- 烤火腿鸡蛋蔬菜三明治 (约550千卡)
Roasted Ham, Egg, Grilled Vegetable Sandwich
Portion/例 68



意面 PASTA

- 鲜虾罗勒意面 (约580千卡)
Fresh Shrimp Basil Pasta
Portion/例 88

米饭 RICE

- 番茄黑椒鸡扒杂粮饭 (约460千卡)
Tomato Chicken Multigrain Rice
Portion/例 88

酸奶 YOGURT

- 蓝莓酸奶碗 (约360千卡)
Blueberry Yogurt Bowl
Portion/例 68

How to Use Alipay and WeChat Pay

Alipay and WeChat Pay are two important payment methods in China. Learning how to use them will make your travel to China much easier. Click on the PDF link below to learn more.



[Alipay Use Introduction.pdf](#)



[WeChat Pay Use Introduction.pdf](#)

Meeting Staff

If you need any assistance during your stay, you may go to staff at the Information desk outside the meeting room. For any emergency please contact us at:

CCSA Mr. BAI Ruixiao (+86-15501150226)



Have a successful meeting and

enjoy your stay in Hefei!