

The guide for a smooth 3GPP mega meeting 19-23 August 2024 in MECC, Maastricht



Outline

- ✓ **ETSI** is happy to welcome you in **Maastricht**.
- ✓ The goal of this guide is to describe the architecture of this event: 3GPP WGs will take place in one place. Let's zoom on the logistic to make your daily life in **Maastricht** much easier.
- ✓ This guide is dedicated to the 3GPP Delegates, Chairs during the welcome speech.



Welcome to Maastricht

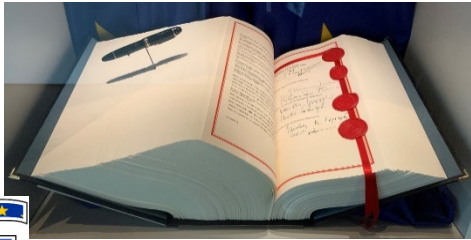

- Maastricht is the capital and largest city of Limburg province in the Netherlands that borders Belgium and Germany
 - Meuse-Rhine Euroregion with Aachen (Germany), Liège and Hasselt (Belgium)
- Population: app. 122k.
- History of over 2000 years back to Roman times
 - Traiectum ad Mosam: "ford in the Meuse river"
- Maastricht Treaty agreement
 - Foundation treaty EU
 - Birthplace of EURO as a single European currency.

Maastricht - Sightseeing

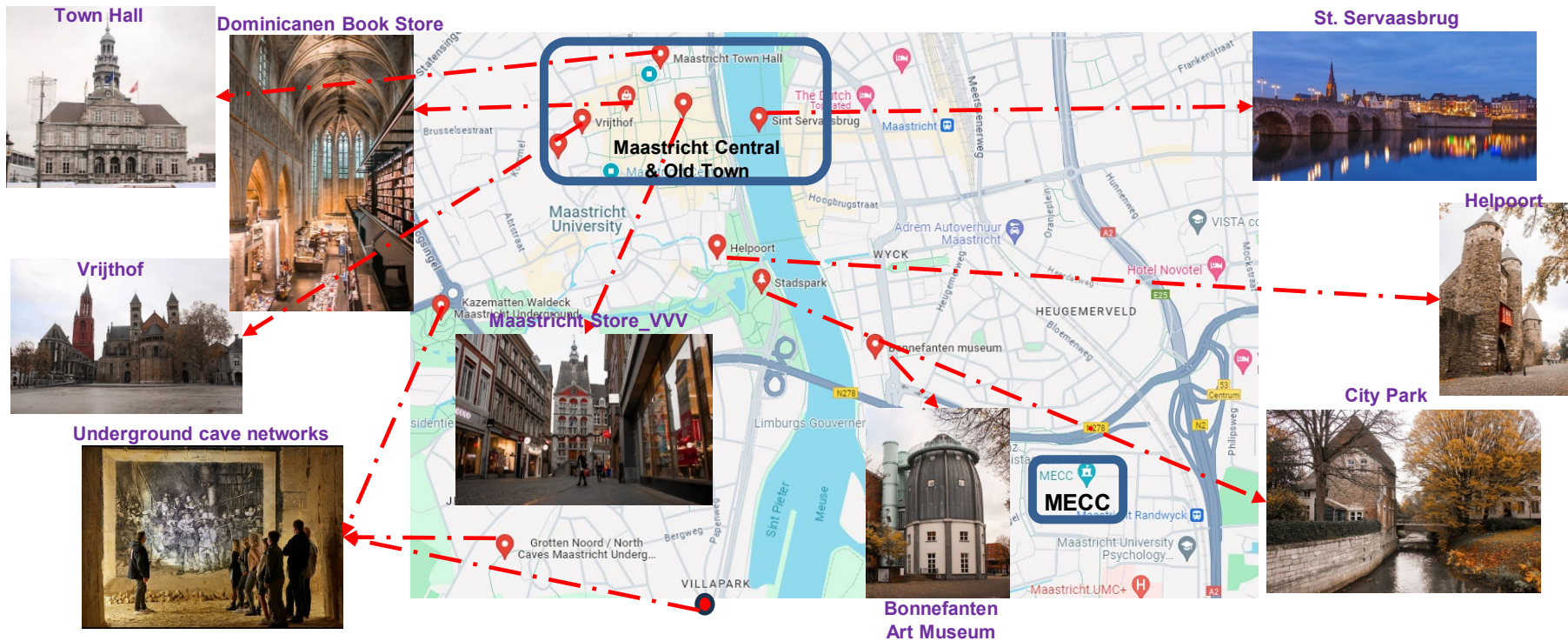

Town Hall

Dominicanen Book Store

Vrijthof

Underground cave networks

Maastricht Central & Old Town

Maastricht Store_VVV

Helipoort

City Park

St. Servaasbrug

Bonnefanten Art Museum

- Vrijthof is the location of famous Maastricht-born conductor André Rieu's annual summer concert



Airport Shuttles

If you need some airport shuttle, please contact

<https://airport-taxi-maastricht.nl/>

T [+31 \(0\)43 781 0003 / +31 6 84 31 32 33](tel:+31684313233)

E info@airport-taxi-maastricht.nl

W www.airport-taxi-maastricht.nl



Public transport NL

Multiple transport companies, e.g.:

- NS (train)
- Arriva (train, bus)

However, all accept OV-Pay (country-wide): you can use your

- **(Foreign) Mastercard or VISA credit cards**
- **(Foreign) Maestro or V-Pay debit cards**

to pay for your journey **without getting a separate ticket**

You just '**check in**' (touch) on entering and '**check out**' (touch again) on exiting; your statement will show the charges

<https://www.ovpay.nl/en/how-it-works>

Plan your journey with <https://9292.nl/>



Maastricht - plane



🌐 **Maastricht-Aachen Airport:** is 10 km from MECC Maastricht, from where MECC Maastricht can be reached within 15 minutes by taxi and bus.

🌐 **Eindhoven Airport:**

- Taxi: ~ 1hr 10 min.
- Train: ~ 2hrs. Forum MECC (bs) → Maastricht (bs/ts) → Eindhoven Central station (ts/bs) → [Hermes Bus 401] → Eindhoven Airport

🌐 **Brussels Airport:**

- Taxi: ~ 1hr 20 min.
- Train: ~ 3hr 30 min. Forum MECC (bs) → Maastricht (bs/ts) → 's Hertogenbosch (ts) → Breda (ts) → [by: NS international] → Brussels Airport
- Bus: ~ 2hr 50 min. Forum MECC (bs) → Maastricht (bs) → [by: Flix bus N84] → Leuven (Perron 15) / Leuven (metro) → Brussels Airport

🌐 **Dusseldorf Airport:**

- Taxi: ~ 1 hr 30 min.
- Train: ~3 hrs. Maastricht Randwyck (ts) → Roermond (ts) → Venlo (ts) → Dusseldorf Hbf (ts) → Dusseldorf Flughafen (ts)

🌐 **Amsterdam Schiphol Airport:**

- Taxi: ~ 2 hr 20 min.
- Train: ~ 3 hrs. Forum MECC (bs) → Maastricht (bs/ts) → Eindhoven Central (ts) → Schiphol (ts)



How do I reach the venue, MECC Maastricht?

MECC Maastricht is just a **5-minute walk from Maastricht-Randwyck station** and a stone's throw from Maastricht-Central station. [Click here for more information about accessibility and parking.](#)

City bus company website: <https://www.arriva.nl/>
Name of the **bus stop** for the MECC venue: '**Forum MECC**', line 7



Maastricht - bus



bus will be the best option to get to the MECC (bus stop "Forum MECC", line 7).

On average, every five minutes a bus leaves from Maastricht center or Maastricht Central to MECC Maastricht (Forum MECC bus stop).

Plan your trip via 9292.nl

Forum MECC
bus stop

MUMC
bus stop

NH Maastricht
Hotel

Randwyck
bus stop

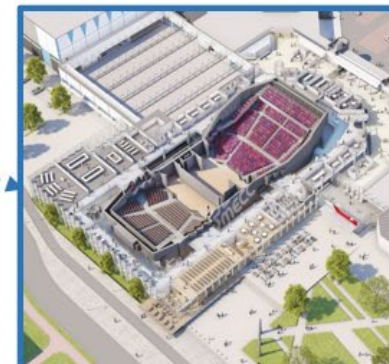



Maastricht - train

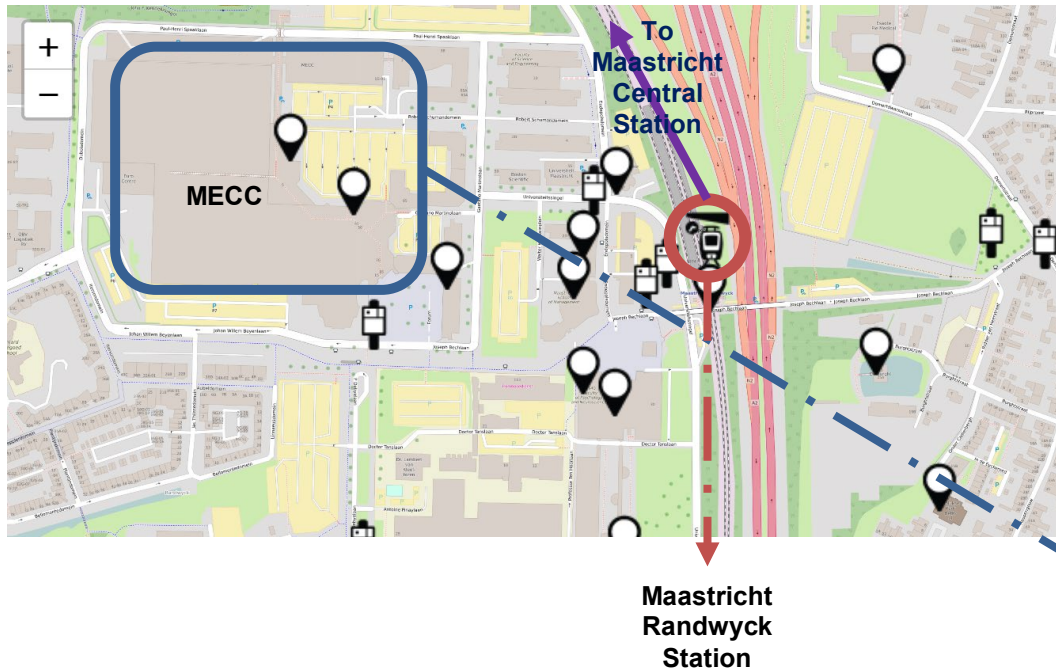

Maastricht-Randwyck station is 250 meters away from MECC Maastricht and is connected to an international railway network. In addition, there is a regular connection to **Maastricht Central Station**, which is connected to the (inter)national railway network.

Plan your trip via 9292.nl

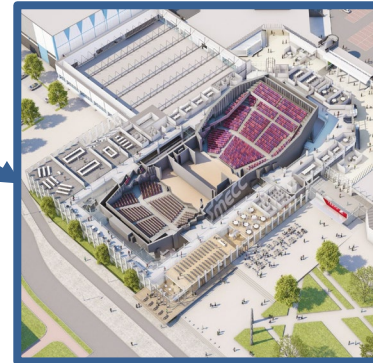



Car park at MECC Maastricht

- Parking for one day costs €19.00 euros.
- You can order your parking ticket in advance using this link [MECC Maastricht Parkeren](#)
- Persons with an electric car should register in advance with claire.gauthier@etsi.org or emmanuelle.wurffel@etsi.org.
You will be directed to another parking lot so you can charge your car there.



MECC opening/closing time

07:30-20:30

No access on Sunday



Meeting rooms

CT meetings

- **Room W 2.1 Euro (Euro center, level 2): 3GPP CT1#150** for 90 people (Monday-Friday) - Breakout room 1.4 Alpen
- **Room 2.9/2.10 Meuse/Rhine (level 2): 3GPP CT3#136** for 55 people (Monday-Friday) - Breakout room 2.16 Amazon
- **Room 0.14 Singapore (level 0): 3GPP CT4#124** for 70 people (Monday-Friday) - Breakout room 2.4 Congo
- **Room 2.5 Rhone (level 2): 3GPP CT6#119bis** for 12 people (Tuesday-Friday)



Meeting rooms

RAN meetings Monday-Friday

- **Expo Foyer (level 1)**: **3GPP RAN1#118** for 500 people - Breakout rooms: (0.4 Brussels - 120 pax) (2.18/2.19 Mekiong/Madeira - 120 pax) (0.8 Rome - 60 pax) (Praetorium, level 0 - 177 pax)
- **Room 2.1/2.2 Volga/Zambezi (level 2)**: **3GPP RAN2#127** for 300 people - Breakout rooms: (0.9 Athens - 50 pax) (0.15 Washington - 180 pax) (0.2/0.3 Berlin/Copenhagen - 81 pax)
- **Room 1.1 Himalaya (level 1)**: **3GPP RAN3#125** for 120 people - Breakout room 0.1 London
- **Brightlands Foyer (level 1)**: **3GPP RAN4#112** for 300 people - Breakout rooms: (1.6 Dolomites - 114 pax) (0.5 Paris - 120 pax) (1.5 Transantarctic - 51 pax)
- **Room 0.11 Cape Town (level 0)**: **3GPP RAN5#104** for 130 people - Breakout room 0.6/0.7 Madrid/Lisbon



Meeting rooms Layout

SA meetings Monday-Friday

- **MECCSuite (level 1)**: **3GPP SA1#107** for 120 people - Breakout room Dollar/Yen (level 2 Euro Centre)
- **MECCAtable (level 1)**: **3GPP SA2#164** for 300 people - Breakout rooms: (1.3 Vercors - 105 pax) (1.9 Rocky Mountains - 79 pax)
- **Room 0.10 Sydney (level 0)**: **3GPP SA3#117** for 120 people - Breakout room 2.11/2.12 Euphrates/Tigris
- **Room Florin (Euro Centre, level 2)**: **3GPP SA5 #156** for 120 people - Breakout room SA5 CH 0.13 Lima
- **MECCafé (level 1)**: **3GPP SA6#62** for 76 people - Breakout room 2.3 Mississippi



Room plan level 0

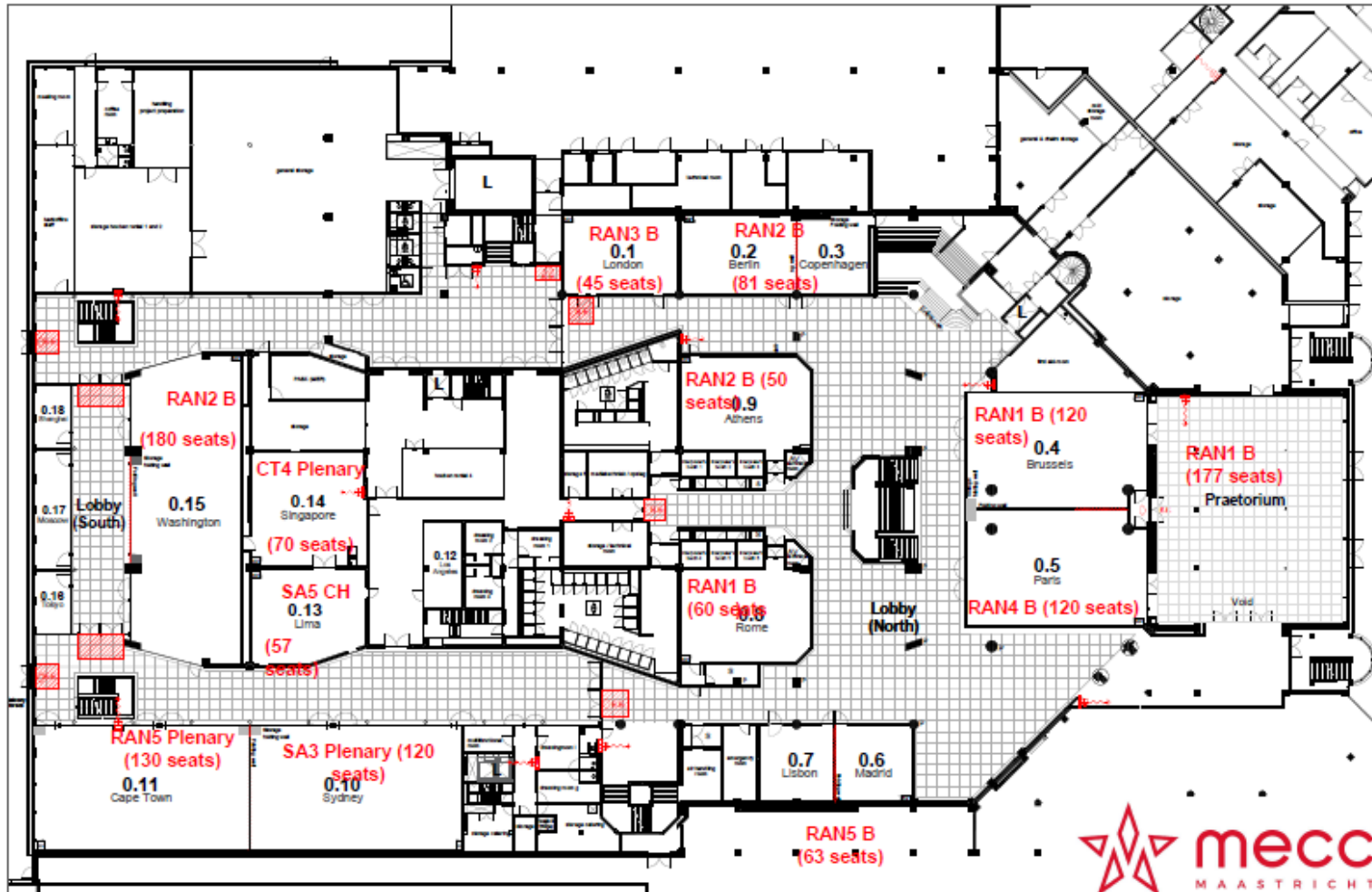

Congress Centre 2020

Plan Level 0

Standard

Version: 12-11-2020



Room plan level 1

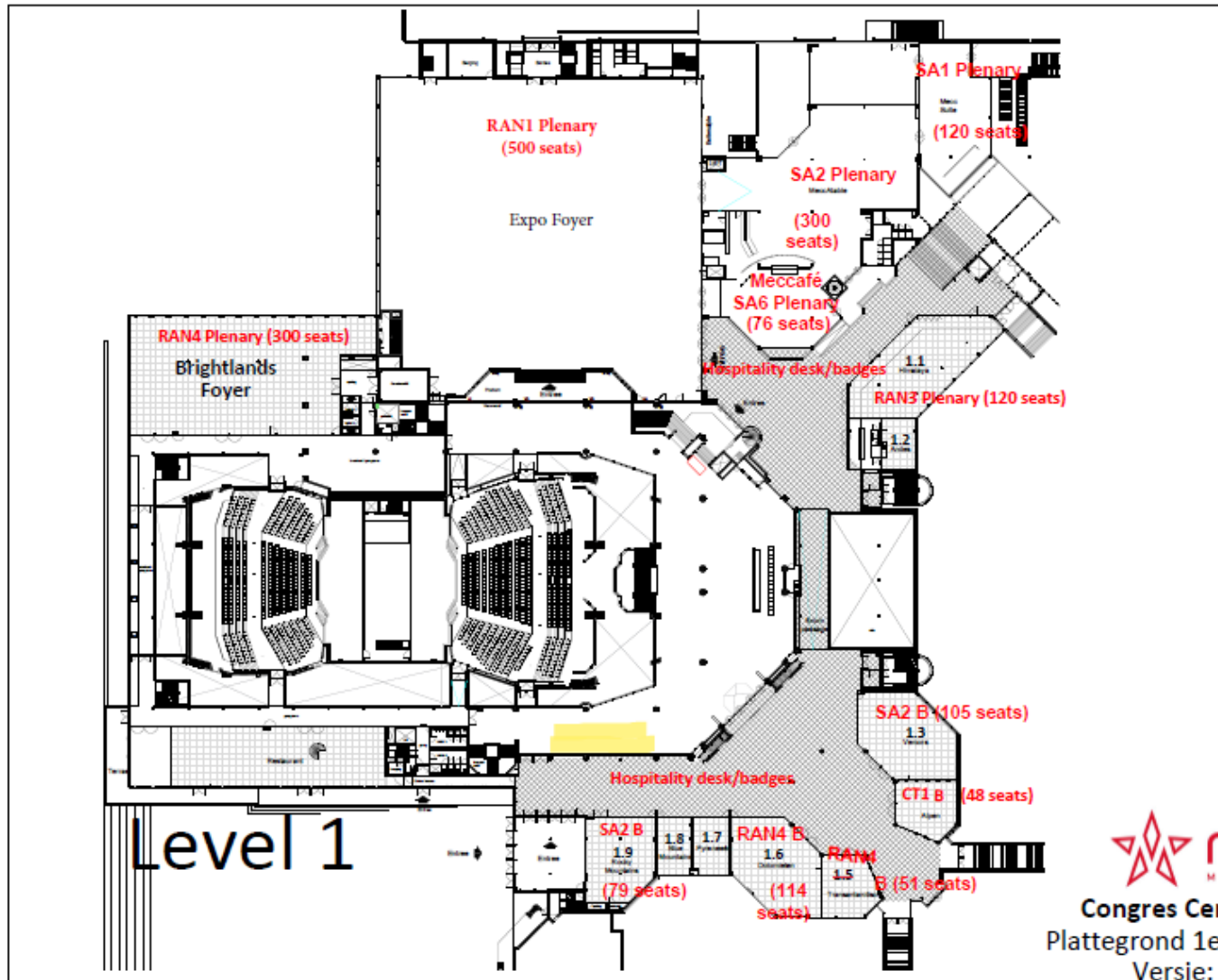

Room plan level 2

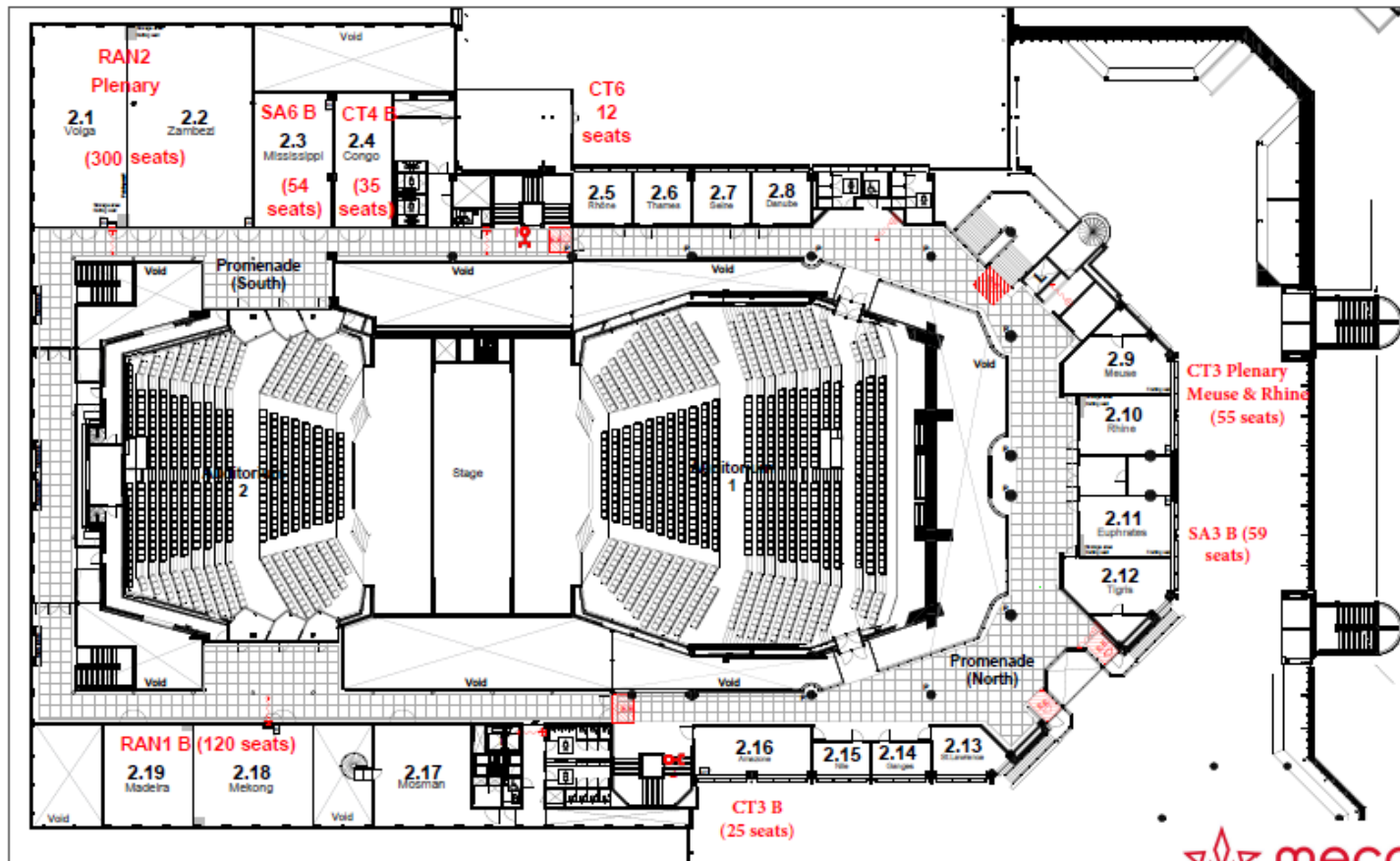

Disclaimer: Aan deze tekeningen kunnen geen rechten worden ontleend. De werkelijke situatie kan afwijken van de tekening. Alle maten moeten nog worden gecontroleerd na oplevering bouw.



Room plan Euro Centre level 2

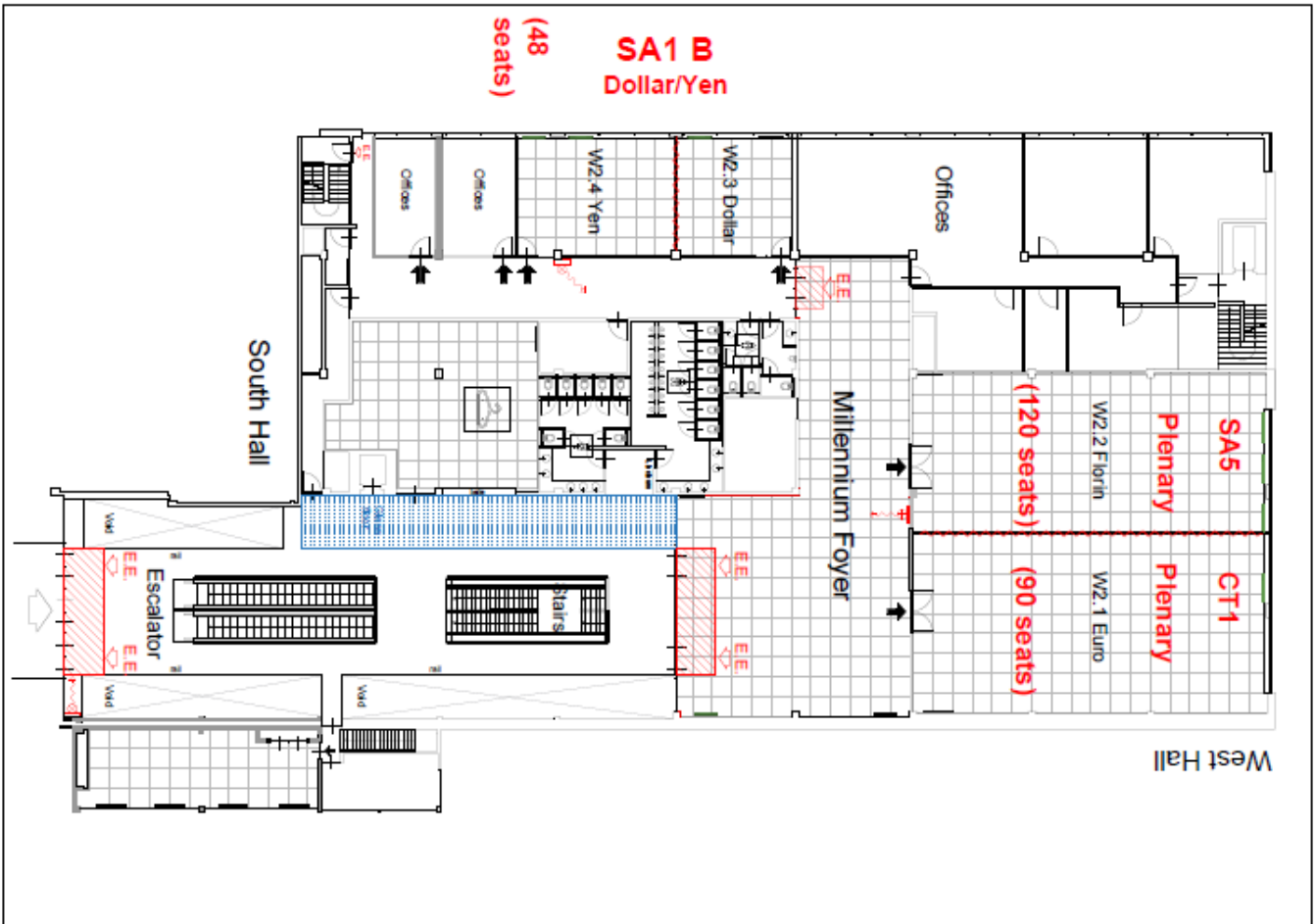

Euro Centre Level 2

Plan 'Standard'

Version: 25-02-2021



Meeting access control - Badge

Registration and badge:

Please register on the 3GPP Portal (same process as usual)

The confirmation email will contain the usual token as well as a QR code

Delegates already registered do not need to register again

When entering the meeting venue, please make sure that you have your QR code available (either on paper or on your mobile phone)

On our first day of meeting, please scan your QR code on the self-printing desk located at the 3GPP hospitality desk & self printing badge, Forum passage Left and Forum passage Right, level 1 (see the 2 yellow desks and badge areas in the floor plan on the next slide)

Your badge will be printed (one badge for all the groups).

**Please wear your badge all week.
Your badge will be scanned regularly by our
Hostesses
(from Monday PM).**



Hospitality desks/badge areas (level 1)

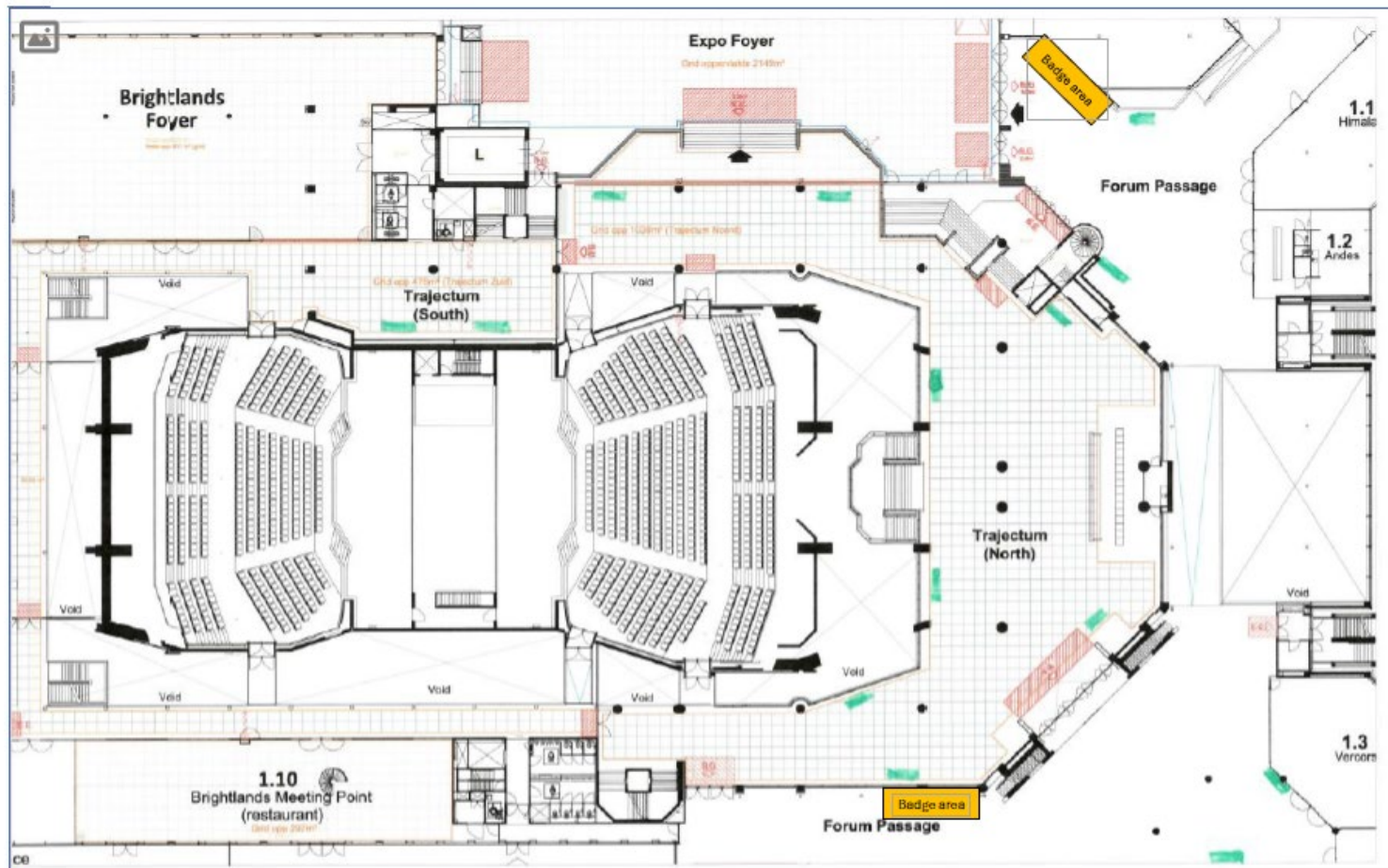



**Bring your
cup or your
water
bottle!**

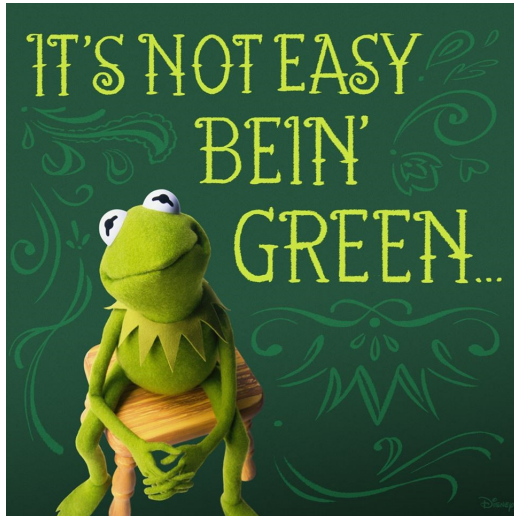

*Be green - In case you
brought
your own cup of tea/coffee
& your water bottle please
feel free to use them at
coffee break*



3GPP coffee breaks

10:30-11:00

15:30-17:00

(except on Friday PM)

Where:

Lobby, level 0

Trajectum & Forum, level 1

(see floor plans in the next slides)



3GPP coffee stations on level 0 - represented in green on the map





3GPP coffee stations on level 1 - represented in green on the map

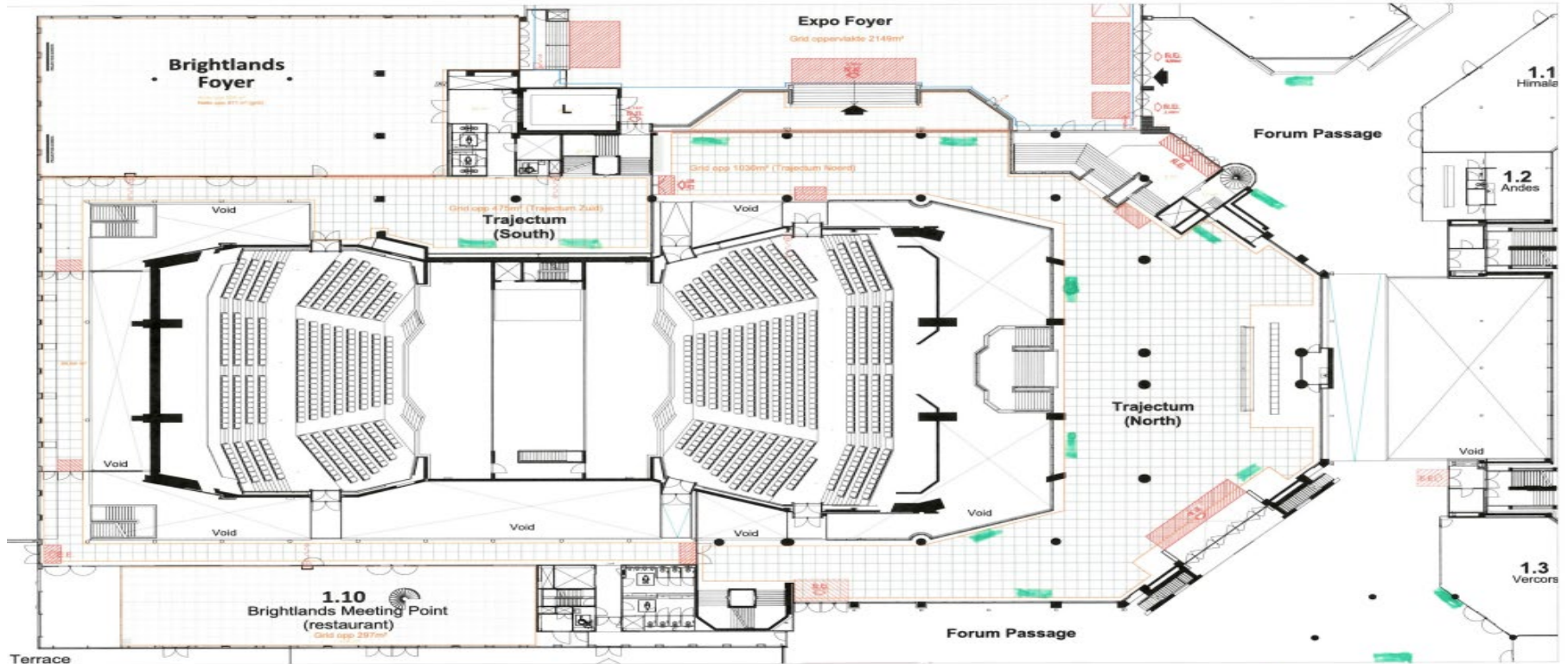

Congress Centre 2020
Plattegrond Nivo 1 - Oppervlaktes
Versie: 27-10-2020



LUNCH

The lunch will be served from 11.30 – 14.15*

- Indoor snacking area *

(corridor of the congress center,

tables & chairs available on the square in front of
MECC)

- Sam Restaurant *

- NH restaurant

Maastricht – Restaurants & cafés

Here you can find some areas with cafe's and restaurants, we also advise you to check google maps (more choices available in the city centre). Kitchens in NL close around 9PM.

Levantini:
Vegeterian

Vino&Friends:
Italian
Le Fernand:
French
Café Sjik: Traditional
Dutch

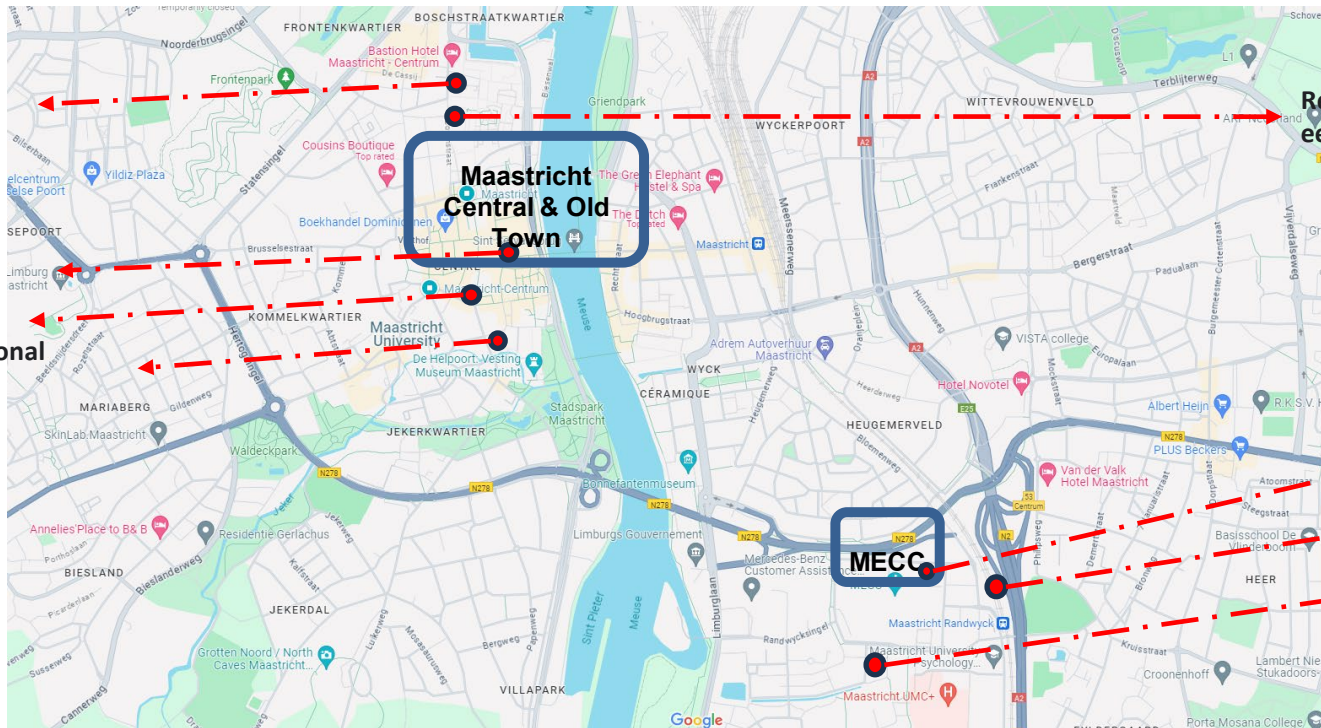

Restaurant Maastricht,
eetcafé Minckelers

Bar Bistro Saam

Kebab XL: Halal

Rivazza: Lunch

20 minutes walking distance to downtown!



Cuisine

- Indonesian(-inspired) food is a Dutch speciality, found e.g. at Chinese ("Chin.Ind.") restaurants
- Typical Dutch: rijsttafel – "rice table", a shared feast: <https://en.wikipedia.org/wiki/Rijsttafel>
- A small glossary selection
 - atjar – pickled vegetables; atjar tjampoer (mixed pickles)
 - babi ketjap – pork belly braised in sweet soy sauce
 - babi panggang – roasted pork in a tomato based sauce
 - daging smoor – beef stew
 - gado-gado – vegetables (cooked or fresh) with peanut sauce
 - kroepoek – prawn crackers
 - loempia – spring roll
 - nasi goreng – fried rice
 - nasi rames – "rijsttafel on a plate"
 - pisang goreng – banana fritters
 - rendang – aromatic spicy caramelized beef, braised in coconut milk, chillies, and spices
 - sambal – chilli paste, e.g.: sambal manis (sweet); sambal katjang (peanut sauce); sambal oelek (spicy)
 - saté – various thinly sliced meats, marinated then broiled on a skewer, such as: sate ayam (chicken); sate babi (pork); sate udang (prawn)
 - sajoer lodeh – vegetable stew (spicy) in coconut milk
 - seroendeng – peanuts with sautéed shredded coconut
 - taugé – bean sprouts
 - teloer/ikan boemboe bali – hard-boiled eggs/fish sautéed in Balinese spice mixture
 - tjap tjoy – stir-fried vegetables



Restaurants

Within walking distance from MECC

<https://www.nh-hotels.com/en/hotel/nh-maastricht/restaurants>

<https://barbistroaam.nl/>

<https://normandy-maastricht.com/>

<https://www.studio.restaurant/>

<https://flavourzbyserveis.com/>



Download your docs before your arrival!

Delegates are urged to download the documents prior to the meeting.

--> Massive downloads on Monday morning have a huge impact on network performance.



3GPP network

Wireless LAN:

SSID: 3GPPWIFI

Password: 3GPP3GPPM (CAPITAL LETTERS!)

Access to Server:

IP address: 10.10.10.10

Local subnet

10.10.0.0 **/19 (size increased)**



External FTP access

Please note the address to get external FTP access:
maastrichtmecc.3gpp.org

This address will be available from Sunday night.

Reminder:

[3gppmeeting](#)

[RemoteAccess2Docs](#)



We are here to help you

We are located at **the 2 hospitality desks, Forum passage, level 1.**

3GPP hospitality desks & self printing badge areas:

[Forum passage Left](#)

[Forum passage Right](#)

emmanuelle.wurffel@etsi.org or +33 4 92 94 4266 (line forwarded to my mobile phone)

claire.gauthier@etsi.org or +33 4 92 94 4322 (line forwarded to my mobile phone)

jean-luc.freisse@etsi.org & aldric.hiegel@etsi.org (IT)



Survey

We will send you a survey after the meeting.





Summary



Thank You for attending this F2F meeting in Maastricht

Have a fruitful meeting in Maastricht

Take care, stay safe, and travel safe

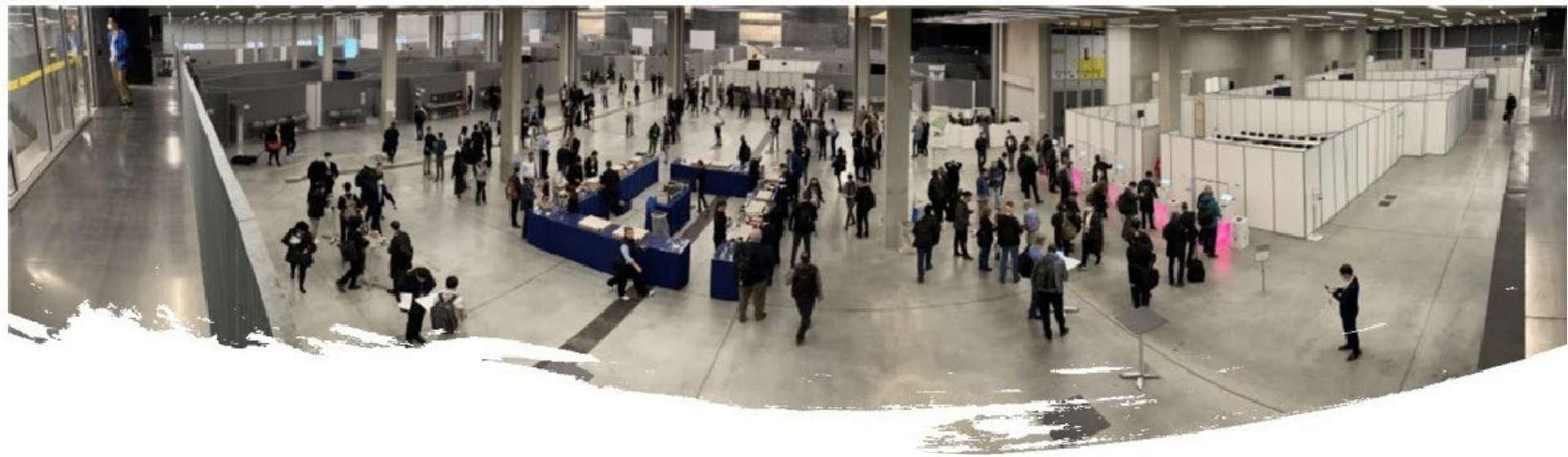

Have a great time in Maastricht!



E3MAG@etsi.org